

**scenic**  
Hotel Bay of Islands

# Conference

EVENTS & INCENTIVES

PROUDLY PART OF SCENIC HOTEL GROUP  
NEW ZEALAND OWNED & OPERATED 

AUG24



# Get together in a kiwi tropical paradise



For more information and to book, visit  
[scenichotelgroup.co.nz/BOI-functions](https://scenichotelgroup.co.nz/BOI-functions)

Nestled in lush tropical gardens and spacious surrounds, the Scenic Hotel Bay of Islands is a four star rated property in the heart of Paihia. We are large enough to cater for events up to 140 guests, yet small enough to provide personalised service for board meetings or executive retreats.

Scenic Hotel Bay of Islands is a fully air-conditioned accommodation and conference venue with dining facilities and assistance with booking leisure activities. Our extensive conference floor area, can be broken down into two smaller rooms or left as one large space, making it ideal for team building, product displays and dinners. We can create tailored menus to suite your specific theme or requirements.

## **CONTACT US**

### **Scenic Hotel Bay of Islands**

58 Seaview Road, PO Box 358, Paihia 0200

E: [boi@scenichotels.co.nz](mailto:boi@scenichotels.co.nz)

[www.scenichotelgroup.co.nz](http://www.scenichotelgroup.co.nz)

0800 NZ OWNED (69 69 63)

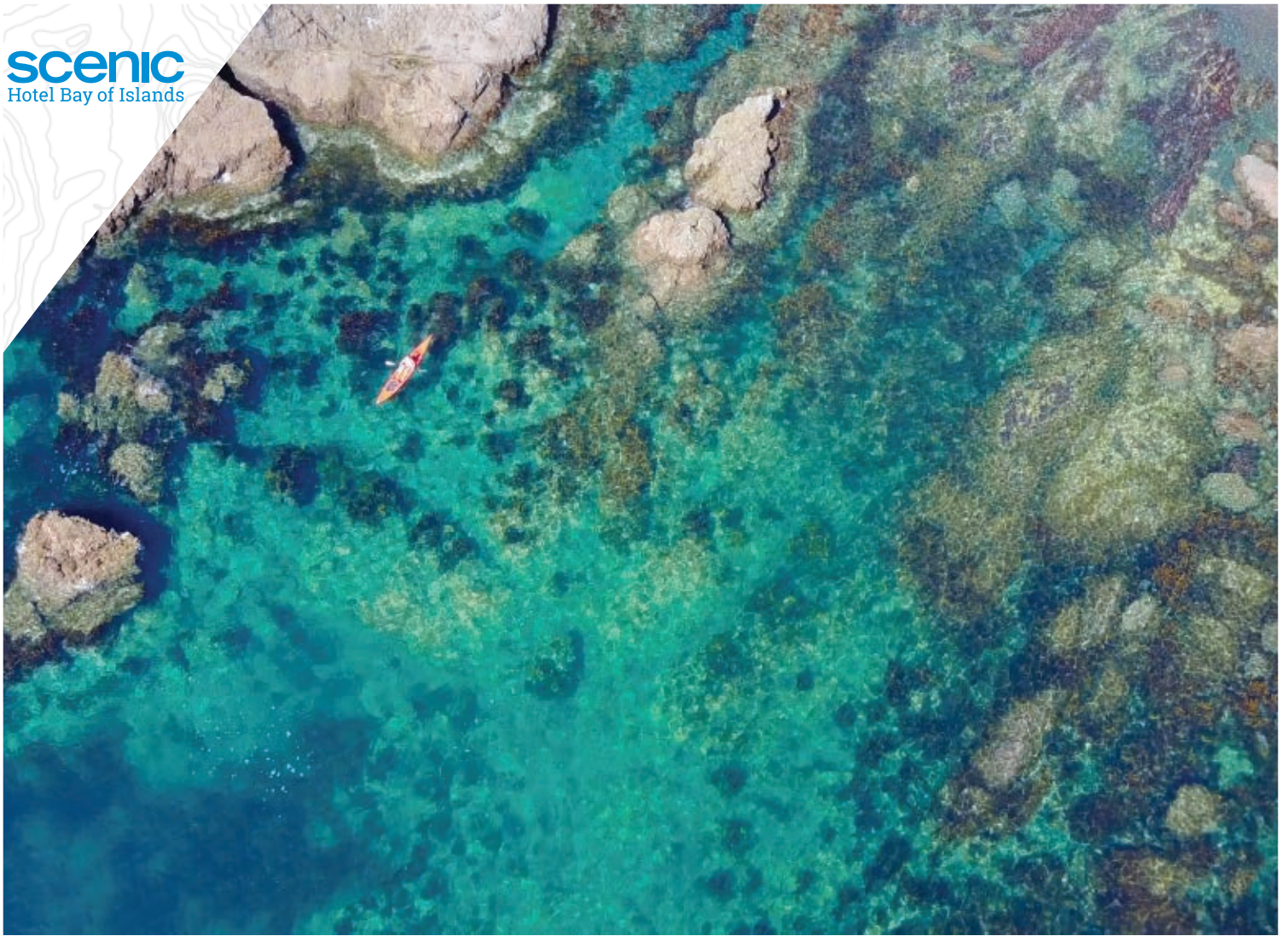

## BAY OF ISLANDS

The beautiful Bay of Islands, known as the 'winterless north', is a popular year-round destination for both tourists and events. It offers a wide selection of world-class activities and attractions. Here it's possible to do as much or as little as you like.

When you come to the Bay of Islands you're treating yourself to a real escape. Whether you just want to chill out and relax or indulge in fishing, golfing, kayaking, swimming or some other exciting activity, it's all here. And our Scenic Hotel Bay of Islands is right in the middle of everything. From Paihia you can do it all, even if that just means lazing by the pool. Let us make your visit both memorable and enjoyable and memorable. Because good service and pleasant surroundings are so important.

### KEY LOCATIONS CLOSE TO OUR HOTEL

+ Airport	<b>23.6km</b>
+ Town centre	<b>500m</b>
+ Beach front	<b>100m</b>
+ Opuia car ferry to Russell	<b>6.3km</b>
+ Cape Reinga	<b>213km</b>
+ Waitangi Treaty grounds	<b>2.7km</b>



## SCENIC HOTEL BAY OF ISLANDS

Scenic Hotel Bay of Islands consists of 114 rooms, situated on four and a half acres of well maintained park like grounds and gardens.

Many of our hotel rooms have their own private balcony, while others open out onto our grassed courtyard or garden areas.

Special accommodation rates are available for your conference guests and we will be delighted to include these great rates in your event quotation.

- + Check in and check out times can be negotiated (subject to availability)
- + Restaurant serving both breakfast and dinner. Lunch available on request.
- + Guests services and conference co-ordinator available
- + Guest lounge bar
- + Guest laundry
- + Valet laundry and dry-cleaning service (available week days excludes public holidays)
- + Swimming pool
- + Free WiFi throughout the hotel
- + Business services
- + Conference facilities
- + Complimentary guest parking
- + Car, boat and coach wash area
- + Tourist information and booking service



## ACCOMMODATION OPTIONS

Set in lush tropical gardens, Scenic Hotel Bay of Islands offers a variety of guest accommodation to suit your needs including family rooms and pet-friendly rooms.

All 114 rooms offer excellent features such as air-conditioning and heating, so you'll be comfortable in summer or winter. Sky TV Channels are available, and you'll have access to free high-speed WiFi, Tea & Coffee making facilities and all beds come with our luxury mattress-toppers for a restful sleep. All rooms have a private en-suite bathrooms which come with complimentary toiletries and a hairdryer. As a bonus most rooms come with their own balcony or patio overlooking lush gardens and hotel grounds.

### STANDARD ROOM

28m<sup>2</sup> 1-2 1-4

### FAMILY ROOM

40m<sup>2</sup> 3 4

### SUPERIOR ROOM









40m<sup>2</sup> 2 4

### DELUXE ROOM

35m<sup>2</sup> 1-2 1-4



## CONFERENCE CAPACITY CHART

Room Layout	Kingfish Room	Albacore Room	Combined
 Theatre	55	60	140
 Classroom	32	32	70
 U Shape	24	24	60
 Board Room	24	24	50
 Hollow Square	24	24	70
 Cabaret	30	30	70
 Cocktail	65	70	200
 Banquet	60	60	140

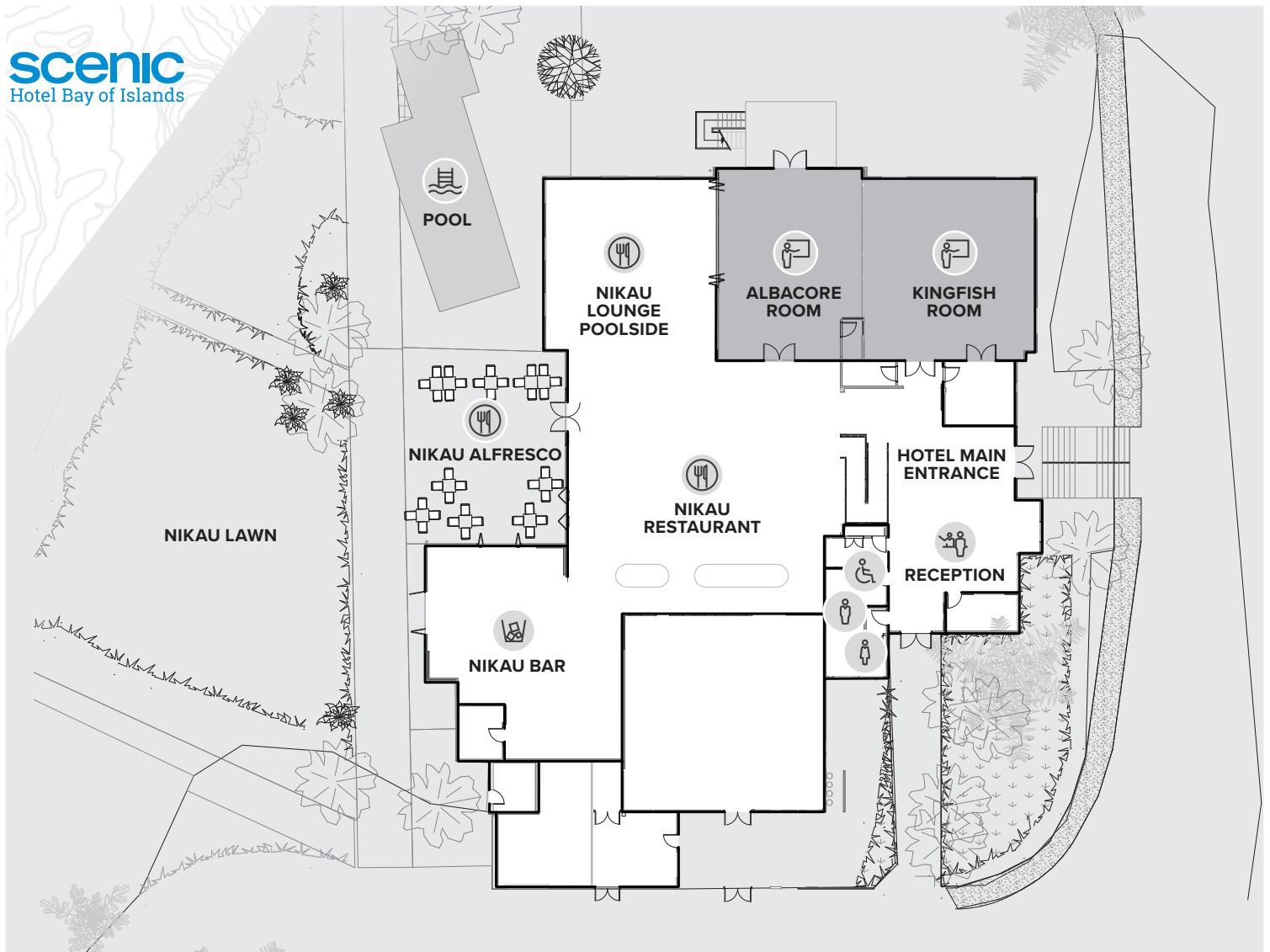

## VENUE DETAILS

### **KINGFISH ROOM \$295 / DAY**

- + 9m x 9m
- + Situated on the ground floor, to the right of reception with the option to extend to the adjacent Albacore room with natural light. Excellent for seminars, product displays or banquets. Fully air-conditioned.

### **ALBACORE ROOM \$285 / DAY**

- + 10m x 8m
- + Situated on the ground floor between the Kingfish room and the lounge with natural light. Suitable for medium to small meetings, training sessions, and seminars. Fully air-conditioned with disability access.

### **KINGFISH & ALBACORE ROOMS COMBINED \$580 / DAY**

- + 19m x 17m
- + These two rooms have retractable walls dividing them which can be opened to cater for larger conferences and functions.

### **DAY DELEGATE PACKAGES**

- + Full day: \$80pp
- + Minimum 20 or more delegates

Special occasion venue rates apply based on catering requirements.



## EVENT DETAILS

### EQUIPMENT HIRE & SERVICES

All conference rooms include the following set up: screen, whiteboard, tables, linen, writing pads, pens, iced water, and mints.

Unlimited WiFi	<b>Complimentary</b>
Car parking	<b>Complimentary</b>
Microphone lapel	<b>Half Day \$300</b> <b>Full Day \$600</b>
Microphone hand held or lectern mounted with audio speakers	<b>Half Day \$300</b> <b>Full Day \$600</b>
Data projector	<b>\$100</b>
Lectern	<b>\$25</b>
Whiteboard	first one: <b>Complimentary</b> Additional <b>\$25</b>
Flip chart with easel	<b>\$25</b>

Any items not listed can be obtained through an independent audio-visual supplier. Prices are subject to application.

All prices are inclusive of GST.

### DAILY DELEGATE PACKAGES

Minimum 20 or more delegates

#### FULL DAY **\$80PP**

- + Package includes:
- + Full day room hire and setup
- + AV equipment including data projector, screen, white board and sound system
- + Tea / coffee / juice on arrival
- + Morning tea — chef's selection
- + Lunch — chef's selection
- + Afternoon tea — chef's selection

### OPTIONS TO ENHANCE YOUR EVENT

Lollies





## DINING DETAILS

### NIKAU RESTAURANT & BAR

A stylish and airy space, with island-influenced architecture and surrounds, and views overlooking the pool and gardens. Expect superb service, with a menu that showcases the finest flavours of the Bay of Islands using the best local produce. Focusing on traditional New Zealand cuisine, Nikau specialises in fresh seafood, stunning meats and inspired vegetarian recipes. The bar specialises in award-winning wines (made in New Zealand), as well as craft beer and cocktails.

### HOME GROWN

Celebrating New Zealand businesses doing incredible things – from the hard-working and caring farmers, growers, fisheries to production manufacturing businesses and other tourism operators, leading the way with innovative and sustainable products. Scenic Hotel Group is about supporting these people and business of New Zealand's economy. From food and beverage to wool, wood, and manufactured products.

Each season our Executive Chefs create sensational dishes to tantalise the tastebuds from some of New Zealand's wonderful winter produce. These dishes are available as part of our restaurants' regular dinner service or can be added to your event catering options.

**Dietary Information:** All meals are prepared in a facility using products containing allergens. Please advise the restaurant team of allergies or intolerances. Our chefs pride themselves on sourcing the freshest seasonal food and beverage, so menus are subject to change.

## EVENT CATERING OPTIONS

Breakfast	From \$16.50 pp
Arrival Tea & Coffee	From \$5.00 pp
Morning or Afternoon Tea	From \$15.00 pp
+ Including one food item	
Lunches	From \$30.00 pp
Daily Delegate	From \$70.00 pp
Canapés	From \$15.00 pp

### DINNER

3 course set dinner	From \$49.00 pp
Buffet dinner	From \$45.00 pp



## ACTIVITY DETAILS

Scenic Hotel Bay of Islands has partnered with some great local operators to take your next conference or event to the next level.

From team building to adventures on the land or water, for more details or ideas contact one of our conference team.

### **Here is a taste of what there is to do in the Bay of Islands.**

- + Have a traditional Pōwhiri, welcome ceremony
- + Discover the history of New Zealand's founding document at the Waitangi Treaty Grounds
- + Scenic or nature cruise tour of the Bay of Islands
- + Hole in the Rock fast boat adventure
- + Get everyone on the same 'Waka' and paddle a Māori War Canoe as a team
- + Private wine tasting
- + Big (or little) game fishing
- + Explore Urupukapuka Island and walk amongst regenerating native bush that is teeming with fascinating and rare wildlife, a completely pest free island
- + Watch chocolate goodness in the making at a local chocolatiers
- + Mingle with the locals at a Farmers Market, taste the artisan goodness of local cheese, preserves Mānuka Honey, real fruit ice cream and more.
- + Play a round on scenic golf course.
- + Kayak around the bays
- + Day trip to Cape Reinga, the top of New Zealand
- + Ride the Waitangi Mountain Bike Park or Twin Coast Cycle Trail
- + Visit Rainbow Falls
- + Visit the first Capital of New Zealand, Russell
- + See the Giants of the Forest, and the largest known living Kauri Tree Tāne Mahuta

# SCENIC HOTEL GROUP

NEW ZEALAND OWNED & OPERATED

Legacy COLLECTION

scenic HOTELS | SUITES | RESORTS

Heartland HOTELS



Scenic Matavai Resort Niue

Scenic Hotel Bay of Islands

Legacy Airedale Hotel Auckland  
Heartland Hotel Auckland Airport

Heartland Ambassador Hotel Hamilton

Scenic Hotel Te Pania

Scenic Hotel Marlborough

Scenic Hotel Punakaiki

Legacy Te Waonui Hotel Franz Josef  
Scenic Hotel Franz Josef  
Heartland Hotel Fox Glacier  
Heartland Hotel Glacier Country  
Heartland Hotel Haast

Scenic Hotel Cotswold

Scenic Suites Queenstown  
Heartland Hotel Queenstown

Scenic Hotel Southern Cross  
Scenic Hotel Dunedin City