

scenic
Hotel Dunedin City

Conference

EVENTS & INCENTIVES

PROUDLY PART OF SCENIC HOTEL GROUP
NEW ZEALAND OWNED & OPERATED 

AUG24



Inner city style in the heart of Dunedin



For more information and to book, visit
scenichotelgroup.co.nz/DCH-functions

Located in the central city, the Scenic Hotel Dunedin City is a contemporary property of award winning design. This stylish hotel incorporates clean lines, attractive local artworks and dramatic features that are softened with natural elements including timber, cedar venetians and neutral tones.

Many of the spacious guest rooms offer views of the city or harbour, while the street-side Princes on Dowling Restaurant is the perfect central city location. Our lounge bar is a great place to relax, and is just a short walk from the Octagon, Railway Station and shopping.

CONTACT US

Nadia Oxy | Hotel Manager
Scenic Hotel Dunedin City
Corner of Princes and Dowling Streets
PO Box 618, Dunedin 9054
P: 03 470 1470
E: dch@scenichotels.co.nz
www.scenichotelgroup.co.nz
0800 NZ OWNED (69 69 63)



OTAGO, DUNEDIN

Called the 'Edinburgh of the South', Dunedin is New Zealand's oldest city and traces its history back to its Scottish settlers. It boasts a unique combination of cultural riches, fine architecture and world-famous wildlife reserves on the Otago Peninsula.

Dunedin is fast becoming known for its incredible fashion, street art and artisan values, and with the eclectic vibes of the student life mixed with a bustling business district and traditional heritage there is a wide range of experiences on offer.

KEY LOCATIONS CLOSE TO OUR HOTEL

+ City Centre	200m
+ Dunedin Public Art Gallery	230m
+ Otago Museum	1.6km
+ Larnach Castle	13.5km
+ Airport	28km



SCENIC HOTEL DUNEDIN CITY

This stylish inner-city hotel is in the ideal location to discover all that Dunedin has to offer.

Flooded with natural lighting and soft, contemporary detailing, spacious guest rooms, modern facilities, and attractive local artworks, Scenic Hotel Dunedin City presents a relaxing yet chic setting for business and leisure travellers.

- + Check-in time: 2:00pm
Check-out time: 10:00am
- + Princes on Dowling Restaurant
- + 24-hour reception
- + Two guest laundries
- + Valet laundry and dry-cleaning service
- + Gym
- + Free WiFi
- + Business services
- + Car parking. Booking essential for on-site parking. Alternative options available within a short distance from the hotel.

Special accommodation rates apply to our conference clientele and we will be delighted to include these great rates in your conference quotation.



ACCOMMODATION OPTIONS

Our Dunedin Hotel accommodation guest rooms and suites offer good natural lighting with modern styling. Executive rooms and suites all feature a private balcony, and selected rooms have harbour or city views. All rooms and suites include air conditioning, 50" Smart TV capable of casting your device, SKY TV, mini fridge, tea & coffee facilities, hairdryer, and free WiFi. Executive rooms and suites feature bathrobes, capsule coffee maker and executive work desk. There is an accessible bathroom option available in some rooms (on request and subject to availability). Interconnecting room options are also available on request.

STANDARD ROOMS

29m² 1-2 1-3

SUPERIOR ROOMS

31-35m² 1-3 1-4

EXECUTIVE ROOMS

30m² 1-2 1-4





EXECUTIVE SUITES

47-60m² 1-3 1-5

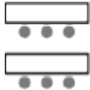

CAPACITY

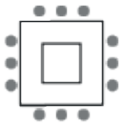
HIGHLAND ROOM LAYOUT

	Theatre	40
	Classroom	24
	U Shape	26
	Boardroom	24
	Square	30
	Cocktail	40

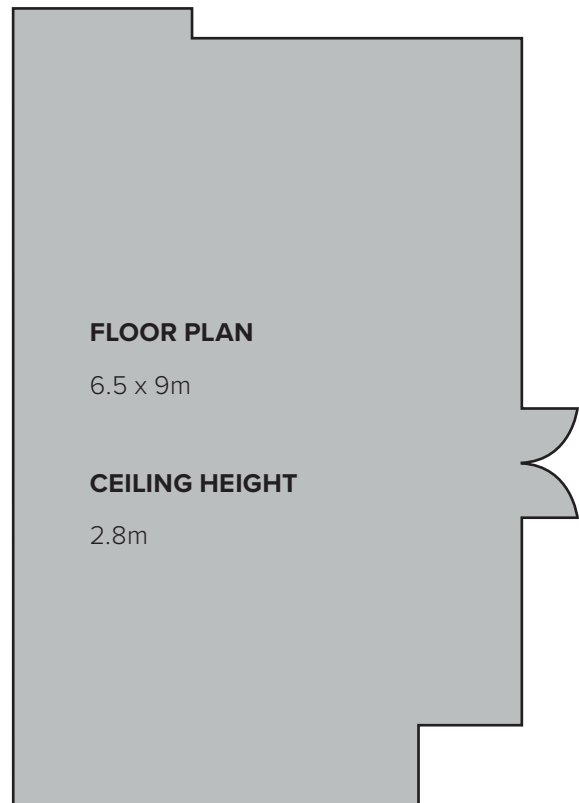



ROOM HIRE COST

HIGHLAND ROOM FULL DAY **\$300**

The Highland room is situated on the ground floor with its own street entry. It is fully air-conditioned and excellent for a wide range of events.

FULL DAY HIRE

DAILY DELEGATE RATE **\$60PP**

Minimum 10 delegates.

Includes: Conference room hire, basic equipment (flip chart, whiteboard, pens and screen), morning tea (one option), working lunch, and Afternoon tea (one option).

EQUIPMENT HIRE & SERVICES

Unlimited WiFi	Complimentary
Whiteboard	\$25
Flip Chart	\$25
75" Smart TV	\$150
Velcro Pin-Boards	\$25
Data Projector	\$100
Screen	\$25
Lectern	\$25
Meeting Owl Video Conferencing	\$150

Conference rooms automatically come with some basic room set up: pads, pens, iced water, and mints.

Any items not listed can be obtained through an independent audio-visual supplier. Prices are per day, subject to application, and inclusive of GST.



COFFEE BREAKS

Freshly brewed coffee and a selection of teas
served with **one** of the following **\$9.50pp**
served with **two** of the following **\$13.50pp**
served with **three** of the following **\$16.50pp**

SAVOURY SELECTIONS

- mini croissant with ham, brie and tomato
- smoked salmon and cream cheese on mini rye bread rolls
- mini focaccia sandwich with hummus grilled peppers and zucchini
- roast vegetable frittata with homemade relish
- savoury scones with butter
- homemade pork, apple and sage sausage rolls

SWEET

- mini chocolate and almond eclairs
- scones with strawberry jam and cream
- a selection of home baked cookies
- raspberry friands
- homemade sweet fruit muffins
- fresh fruit bowl

Dietary Information: All meals are prepared in a facility using products containing allergens.
Please advise of any allergies or intolerances.
We pride ourselves on sourcing the freshest seasonal food and beverage, so menus are subject to change.



WORKING LUNCH SELECTIONS

WORKING LUNCH 1

\$29.50pp

CIABATTA SANDWICH
filled with roast beef,
lettuce, tomato and
horse radish cream

WALDORF SALAD
apple, celery, toasted walnuts
with a lemon cream dressing

GRILLED CHICKEN
boneless chicken breast
marinated with garlic,
lemon and rosemary with
a mushroom, red pepper
and basil sauce

**BUTTERED
DESIREE POTATOES**
steamed baby red
jacket potato finished
with butter, chives and
cracked black pepper

CHOCOLATE BROWNIE
with anglaise
and whipped cream

WORKING LUNCH 2

\$29.50PP

FINGER SANDWICHES
a selection of wholemeal
and white finger sandwiches
including vegetarian options

THAI NOODLE SALAD
vermicelli noodles, mung
sprouts, cucumber,
peppers, and roasted
peanuts with a sesame lime
coriander dressing

HONEY SOY PORK
pork shoulder marinated with
ginger, garlic and lemon slow
roasted till tender served with
a honey soy sauce

PILAFF RICE
braised basmati rice
flavoured with curry and
garnished with peas

**FRESH SEASONAL
FRUIT PLATTER**

WORKING LUNCH 3

\$29.50PP

HAM & SWISS ON RYE
shaved ham, Swiss cheese,
lettuce, tomato and Dijon on
light rye bread

GARDEN SALAD
baby lettuce leaves with
cucumber, cherry tomato and
a balsamic dressing

LAMB KOFTAS
grilled lamb mince kebabs
seasoned with cumin,
coriander and paprika served
with a minted garlic yoghurt

LEBANESE BULGUR
cracked bulgur wheat braised
with tomato, red peppers,
olives, currants and saffron

**BAKED RICOTTA
CHEESECAKE**
flavoured with lemon
and vanilla, served
with berry coulis

Dietary Information: All meals are prepared in a facility using products containing allergens.

Please advise of any allergies or intolerances.

Please note all catering arrangements are served in the conference room.

Lunch could be also served in the Princes On Dowling Restaurant on prior arrangements.



ACTIVITY DETAILS

Scenic Hotel Dunedin City has partnered with some great local operators to take your next conference or event to the next level.

From team building to easy activities or grand adventures, there are options for all. For more details or ideas contact one of our conference team.

HERE IS A TASTE OF WHAT THERE IS TO DO IN DUNEDIN AND SURROUNDS.

- + Feel like royalty with a visit to Larnach Castle, the only castle here in New Zealand, which has been restored to its full Victorian grandeur.
- + Do the Dunedin Street Art Trail and see some of the incredible murals created by local artists as well as many from around the country and the world.
- + Be charmed by Port Chalmers, only around 20 minutes drive from the city. Visit local artists, musicians and jewellers, and take in the colour and vibrancy from one of the many cafes.
- + Satisfy your sweet tooth with some of the local Ocho Chocolate
- + Embrace the architecture with some of the well preserved buildings built in the Victorian and Edwardian eras, giving it a feeling of history and heritage.
- + Catch a sporting match or maybe an international superstar at Forsyth Barr Stadium – the multipurpose and versatile arena – complete with roof to ensure all year round entertainment.
- + Get up close with nature at some of the various wildlife experiences around the region, from albatross, to Hoiho (yellow eyed penguin), fur seals and dolphins.
- + Surf's always up at St Clair Beach! (just remember your wetsuit!).
- + Don't forget the iconic photo opportunity and must do kiwi experience of a walk up Baldwin Street – officially the steepest street in the world!
- + Take a trip to Orokonui Ecosanctuary, home to rare and endangered native birds.
- + Zip around the harbour trail on an e-bike or mountain bike down Signal Hill.
- + Sample some of Dunedin's distilleries and breweries with guided tours and tastings.

SCENIC HOTEL GROUP

NEW ZEALAND OWNED & OPERATED

Legacy COLLECTION

scenic HOTELS | SUITES | RESORTS

Heartland HOTELS

